

LAKE  
MACQUARIE  
CITY

MAC

Museum of Art and Culture ▲ yapang

📍 First Street Booragul NSW 2284

📍 [mac.lakemac.com.au](http://mac.lakemac.com.au)

☎ +61 2 49210382

VENUE HIRE PROSPECTUS







## WHY HIRE MAC?

Museum of Art and Culture Lake Macquarie, yapang (MAC yapang) is a unique arts and cultural destination situated in a magnificent lakeside location overlooking the Sculpture Park, Marmong Point Marina and extensive leafy grounds. As a long-established arts and cultural venue, MAC yapang attracts and develops a high quality range of exhibitions and programs that are lively, engaging and inspiring.

MAC yapang is available for private hire for your special function or event including cocktail parties, meetings, dinners, ceremonies, small conferences, weddings, product launches or presentations.



## GUIDED TOURS AND PROGRAMS

Make your event even more memorable with a guided tour of the Sculpture Park or current exhibition. Our team can customise lectures, workshops or even a life drawing session to add additional uniqueness to your event.

## EVENTS THAT ARE DIFFERENT

MAC yapang offers not only a pristine and uninterrupted view of the lake, but also a memorable experience that is unprecedented in the Hunter. MAC yapang creates the perfect location if you want something unique, surprising and within a stunning environment. Presenting ever changing exhibitions, there is always something new to see and experience.



## SHOP MAC

Supporting local and national creative makers and designers, shop MAC is an inspiring retail outlet which can be open during your event to provide an engaging shopping experience. You can also pre-purchase corporate or special gifts for your guests.



## SCULPTURE CAFE

Enjoy coffee, cake, or a light lunch with a glass of wine at the sculpture cafe, overlooking the lake and Sculpture Park.



## CATERING

Providing catering for morning teas, cocktail parties, light lunches and formal functions, sculpture café can cater to your next event. Our wine and craft beer partners are Ernest Hill Wines and FogHorn Brewery. Any other alcoholic beverages are to be negotiated with MAC yapang according to our Liquor Licence and partnerships agreement.





# MAC SPACES



## TERRACE



This covered outdoor space overlooking the lake is ideal for cocktail parties, small outdoor cinema events, music and alfresco dining.



-  **60m<sup>2</sup>**
-  **40 seated  
60 standing**
-  **covered outdoor space**
-  **lake views**
-  **cocktail parties**
-  **small outdoor cinema events**
-  **music**
-  **alfresco dining**
-  **accessible**
-  **wifi**

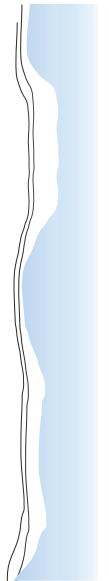
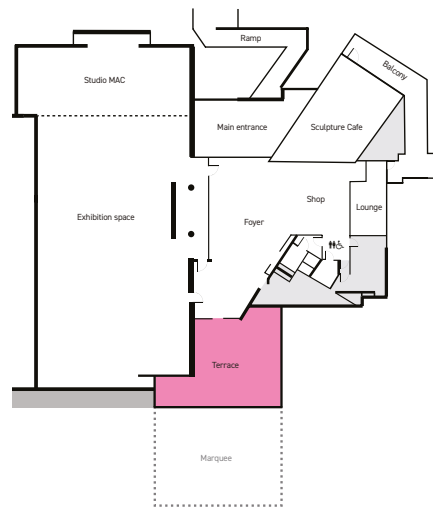



## FOYER, CAFÉ, LOUNGE AND BALCONY



This multi-purpose space with lake and Sculpture Park views can be used for dining, parties or seminars and is open to the Terrace and entry deck. The lounge and balcony can be hired seperately.



-  **after hours**
-  **120m<sup>2</sup> in total**
-  **70 seated  
200 standing**
-  **indoor/outdoor space**
-  **dining**
-  **catering available**
-  **seminar**
-  **access to balcony**
-  **music**
-  **accessible**
-  **wifi**

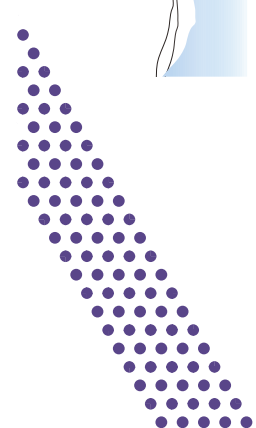



# MAC SPACES



## EXHIBITION SPACE INCLUDING STUDIO MAC



The main exhibition space spans the length of the art museum and is ideal for larger groups. This space is used for the display of touring exhibitions and significant in-house curated projects. StudioMAC is a new multi-use space equipped with seminar and film equipment and features a Collection showcase.

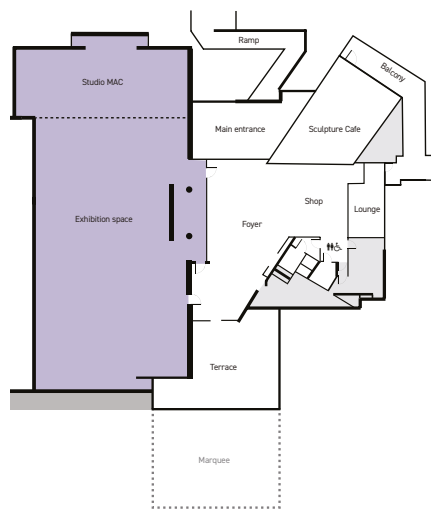

🕒 after hours only and subject to availability

📏 100m<sup>2</sup>–300m<sup>2</sup>

📏 space depends on current exhibition

👤 40–100 dinner-style  
40–60 theatre-style  
100–150 standing

🎨 cultural experience

🏠 indoor space

🍸 cocktail party

🍴 dining

🎬 film nights

♿ accessible

📶 wifi



## MARQUEE (WITH TERRACE)



A marquee can be made available for larger dinners and events. Set up adjacent to the Terrace, it is ideal for formal functions with a break-out bar on the Terrace overlooking the lake, marina and Sculpture Park. The set up cost for the Marquee is \$2,400 if not already on site.

 168m<sup>2</sup> in total

 60 seated  
150 standing

 outdoor undercover

 formal functions

 large dining

 pop-up bar

 music

 accessible

 wifi

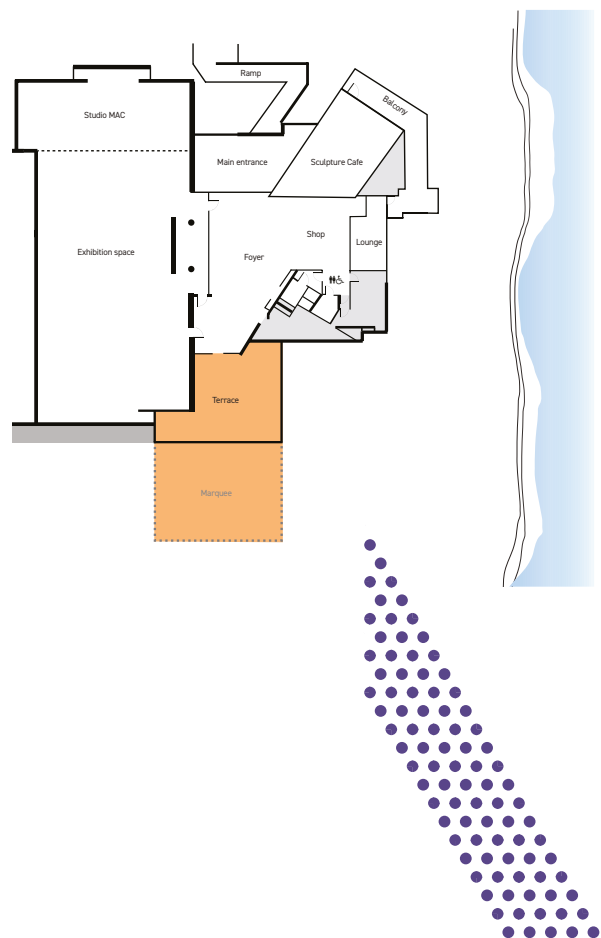



# MAC SPACES





## LOUNGE WITH BREAKOUT BALCONY



The Lounge with a Balcony breakout space is ideal for small lunches or dinners, morning teas or seminars. The space is open to the foyer and can be screened off, but is not sound proof.



 20 seated dinner-style  
25 seated theatre-style  
30 standing

 cultural experience

 indoor space

 cocktail party

 seminar

 dining

 accessible

 wifi

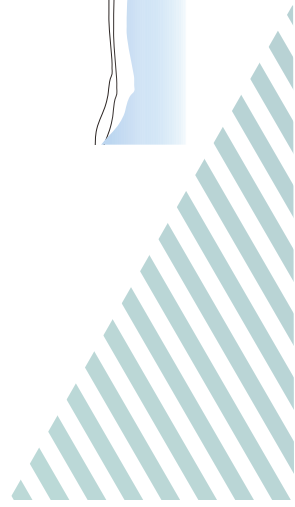
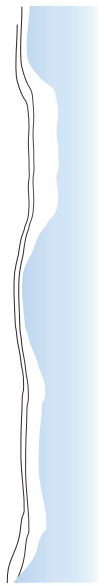
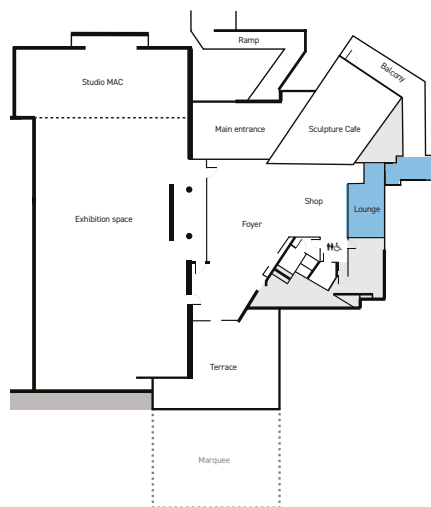



# FEES AND CHARGES

Rates of hire are at a minimum of 2 hours and a maximum of 8 hours per hire period inclusive of 1.5 hours for set up and clean up. All hire allows for access to exhibitions. Inclusion of food and drink in the exhibition spaces is dependent on the current exhibition. MAC yapang is only available for out of hours social functions between 6pm and 11pm inclusive. A non-refundable booking fee of \$35 is required for wedding ceremonies if space not booked outright.

Fees indicated below are per hour, unless stated otherwise.

MAC FOYER / ROOM HIRE		\$
Additional staff member - hourly rate, if more than 80 guests		\$65
Liquor package	Market price	
Set up fee, hourly rate (Minimum charge 1.5hrs)		\$65
Hire of gallery for a social function or event outside of gallery opening hours – per hour or part thereof		\$284
Use of AV equipment – per day or part therefore		\$31

TERRACE		\$
Community rate	During opening hours	\$40
	After hours	\$65
Corporate/ private rate	During opening hours	\$75
	After Hours	\$100

FOYER, CAFE, LOUNGE AND BALCONY		\$
Community rate	During opening hours	\$40
	After hours	\$65
Corporate/ private rate	During opening hours	\$75
	After Hours	\$100

EXHIBITION SPACE INC. STUDIO MAC		\$
Community rate	During opening hours	\$75
	After hours	\$100
Corporate/ private rate	During opening hours	\$100
	After Hours	\$150

MARQUEE (WITH TERRACE)		\$
Set up cost if not on site - total cost		\$2,400
Community rate		\$150
Corporate/ private rate		\$200

LOUNGE WITH BREAKOUT BALCONY		\$
Community rate	During opening hours	\$40
	After hours	\$65
Corporate/ private rate	During opening hours	\$75
	After Hours	\$100

The fees and charges listed are as indicated in the 2020-2021 Lake Macquarie City Council Fees and Charges schedule. Note all other fees and charges are to be found at: <https://portal.lgsolutions.net.au/Fees/Public/LMCC>

#### Definitions:

##### Community Fee:

- The discounted fee charged for not-for-profit community service organisations.
- It is not applicable for government organisations, schools or other organisations that are funded for facility hire or derive an income from the activities.

##### Corporate / Private Fee:

The standard hourly fee charged for all other bookings.

##### Cancellation Fees:

- For bookings cancelled with less than 48 hours notice - full usage fee will be charged.
- For bookings cancelled with 48 hours to one weeks notice - 50% of usage fee will be charged.
- For bookings cancelled with one to two weeks notice - 25% of usage fee will be charged.

# EQUIPMENT HIRE

MAC yapang can provide basic trestle tables with stock chairs for up to 50 people. Any other requirements must be arranged by hirer in consultation with MAC yapang. All furniture brought into the space must have rubber stoppers to protect the floor. Audio visual equipment may be available, please enquire for availability and prices.

## ADDITIONAL INFORMATION

### Exhibitions

MAC yapang is an active public art museum and due to the changing nature of exhibitions, the capacity of the exhibition space may vary in size, availability and intimacy.

### Deposit and Payment

In line with Lake Macquarie City Council space hire and MAC yapang Venue Hire Agreement, a deposit of 25% of the total hire fee is due on booking. Full payment is due no later than 7 days before the hire period.

### Cancellation fee

- Cancellation by hirer within 48 hours of date of hire forfeits 50% of the hire fee.
- Hirer is to negotiate cancellation of hire directly with caterer.
- If for some unforeseen valid reason (such as safety), MAC yapang has to cancel the hire, no fee will be forfeited by the hirer.

### Accessibility

MAC yapang is a public art museum, and as such is accessible to all. It is a single-level building with ramp and path access. There are accessible car parks and ample space for drop offs.

A wheelchair is available as are accessible toilet amenities. Most of the work in the Sculpture Park can be viewed from the pathway but is predominantly situated in a grassed area.

### Covid-19 restrictions

MAC yapang is still available for hire during Government restrictions, within our Covid Safety Plan.

### Staffing

It is a requirement of hire that MAC yapang staff are to be on duty during functions and events to ensure the best experience for you and your guests, and to maintain the security and care of the artwork and art museum.

The number of staff required for each hire period is at the discretion of MAC yapang and will be discussed with the hirer at the time of booking.

Hire fees includes one staff member. If event deemed to need 2 or more, an additional fee will be negotiated with the hirer.

### Liquor sales or supply

All alcohol sales or supply must conform to MAC yapangs' Liquor Licence and comply with NSW Liquor laws. No other Liquor Licence can serve the space.

### Terms and Conditions

All bookings are subject to the Terms and Conditions as set out in the Venue Hire Agreement available from MAC yapang management. Note that hire opportunities will be dependent on existing event and exhibition programming and availability.

### How to Book

Please contact the team at MAC yapang for further information or to make your booking.

☎ 02 4921 0382

@ mac@lakemac.nsw.gov.au







Museum of Art and Culture ▲ yapang

### Museum of Art and Culture Lake Macquarie, yapang (MAC yapang)

- ☎ +61 (02) 4921 0382
- @ mac@lakemac.nsw.gov.au
- 📍 First Street Booragul, NSW 2284
- 👉 mac.lakemac.com.au
- ✉ Box 1906 Hunter Region MC NSW 2310
- 📘 @themacmuseum
- 📷 @themacmuseum

Some images from MACs exhibition program, courtesy of the photographers and artists.